

Pull Bar Assembly Instructions

For E1E Stair Climbers

Item	Description	Qty.	Part No.
A	Pull Bar w/ Grip	1	2006-228
B	Spacer	2	2001-821
C	Spring, RH	1	8018-008
D	Spring, LH	1	8018-006
E	Clamp	2	8264-003
F	Spring Clip	2	2006-230
G	Cotter Pin	2	8008-003
H	Washer	2	8003-005

Tools Required:

- (1) Flat head screwdriver
- (1) Needle nose pliers

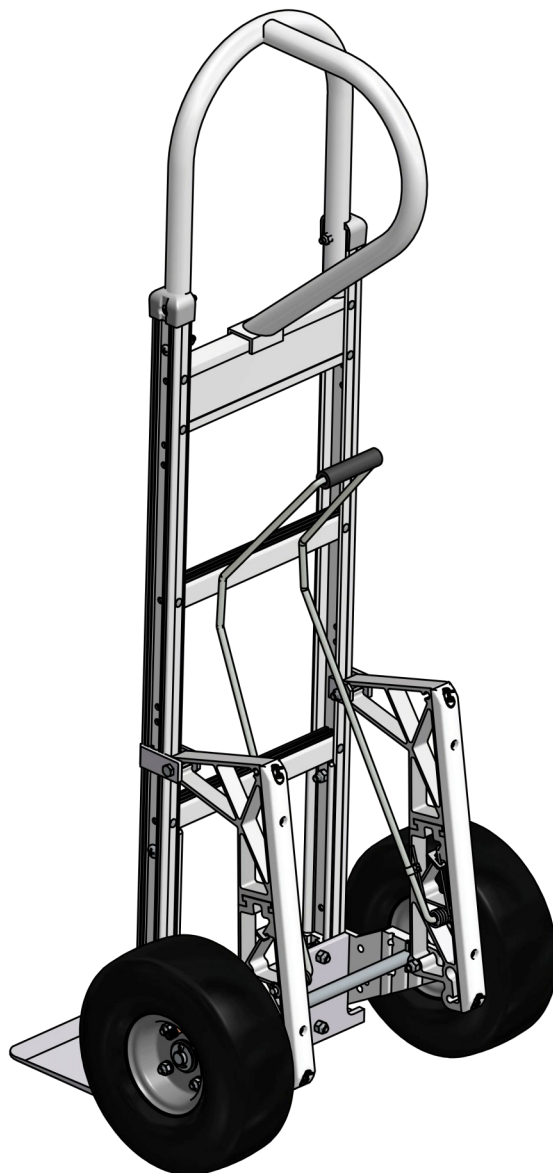
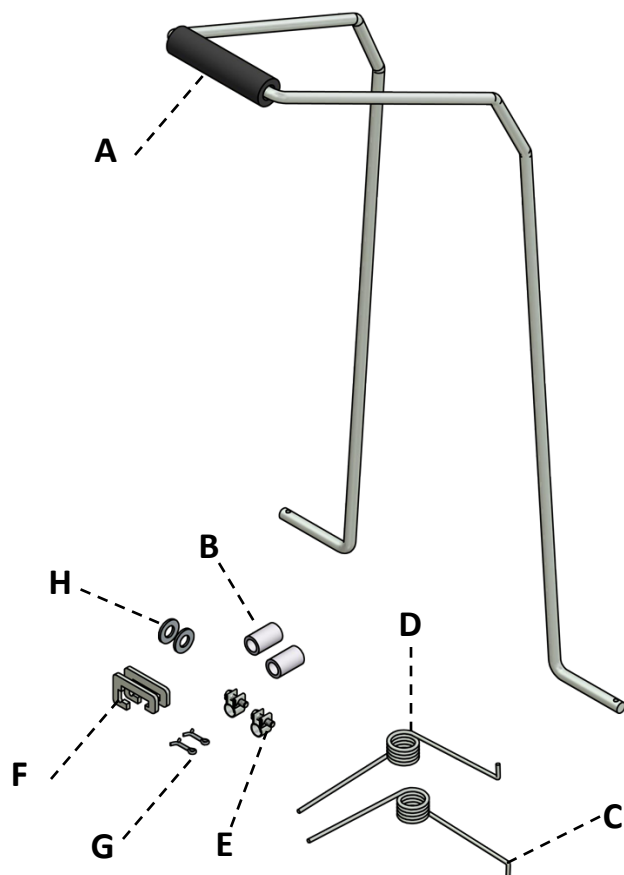

*Handle, frame, nose plate, and wheels will vary based on the options selected at the time of purchase.

www.bpmfg.com

8051 East Boon Road | Cadillac, MI 49601

(800) 334-7141

b&p Manufacturing
Engineered Delivery Products

Pull Bar Assembly Instructions

****To add a pull bar to your hand truck with E1E stair climbers the wheels do not need to be removed but are shown removed in these instructions for clarity.**

1. Slide one spring clip (F) onto the inside of each stair climber in the location shown. Insert the spring (C and D, right side and left side) into the slot in the clip, turn the spring and hook the bent leg of the spring onto the inner edge of the stair climber.
2. Next slide one clamp (E) and one spacer (B) onto each end the pull bar (A) as shown.

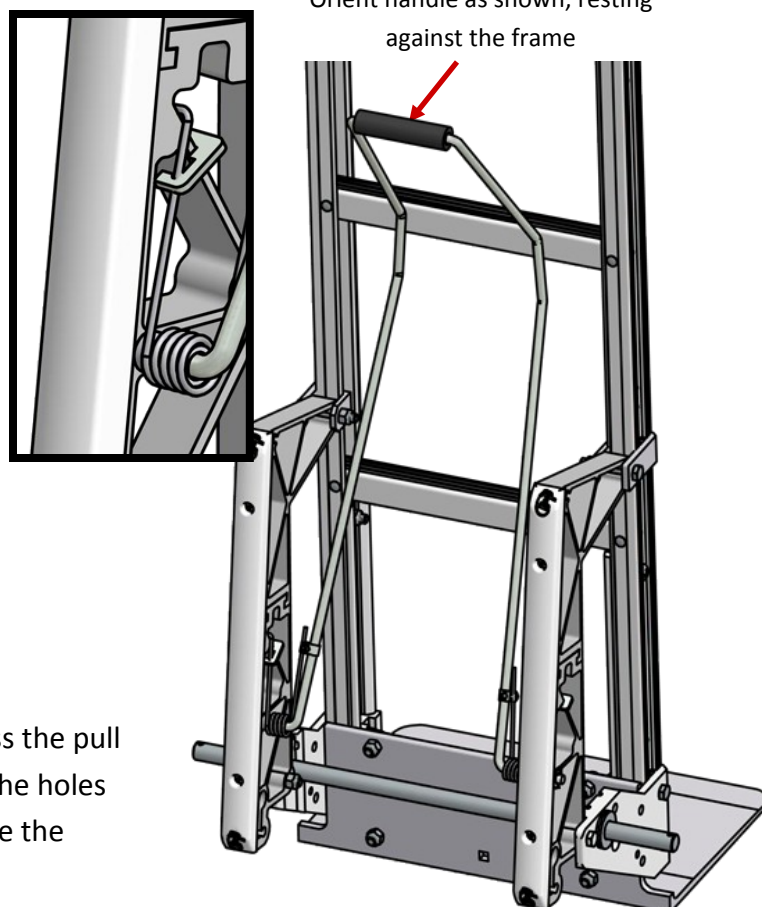
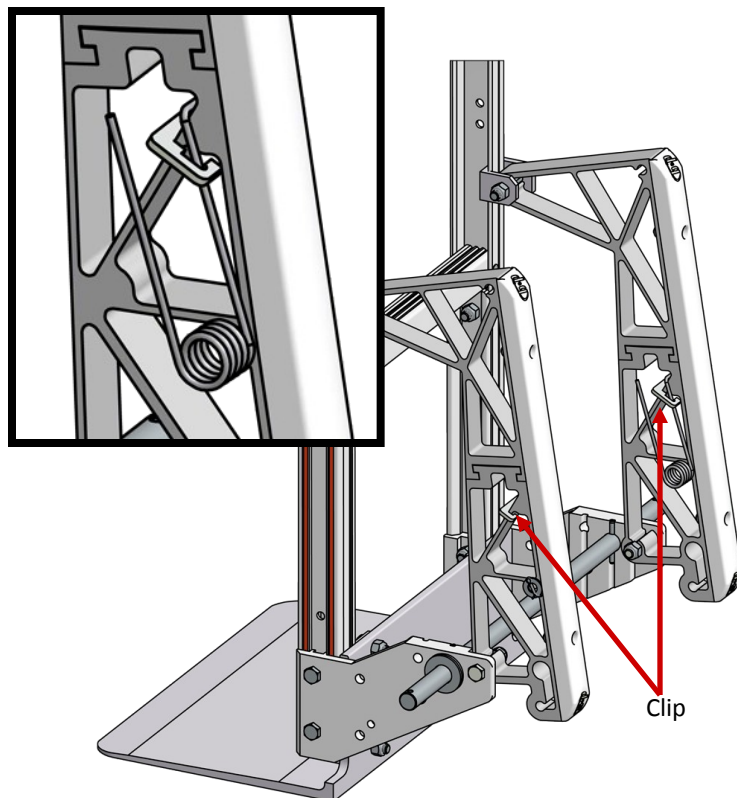

3. Take the pull bar and orient as shown. Compress the pull bar so the ends slide thru the springs and into the holes in each stair climber, the spacers will slide inside the spring coil.

Pull Bar Assembly Instructions

4. Secure the pull bar to the stair climbers with a washer (H) and cotter pin (G).
5. Pull the straight leg of each spring back to align with the pull bar, attach the spring leg to the pull bar by sliding the clamp over the spring leg and tightening the clamp.

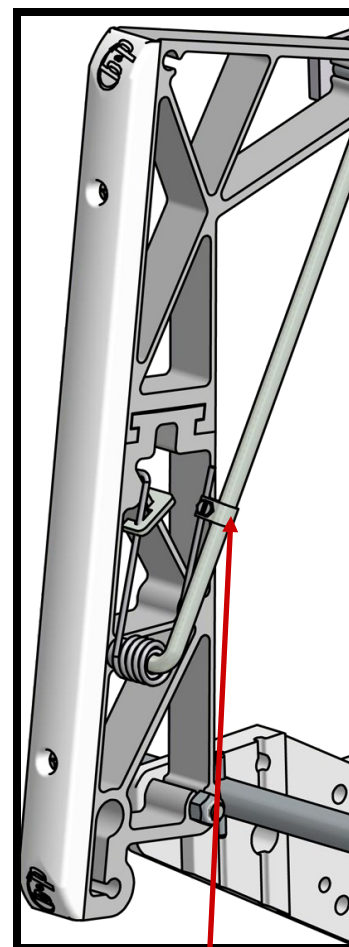
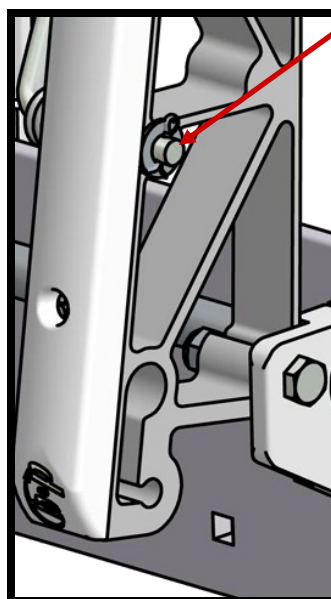
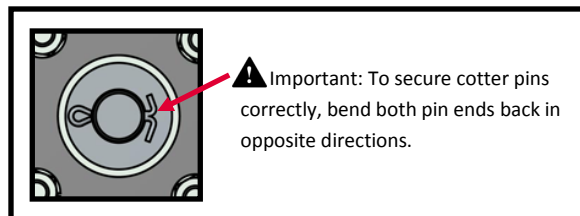

Clamp spring to pull bar