

# E87 Sr. Convertible Ice Pan Kit

## Assembly Instructions

Item	Description	Qty.	Part No.
A	Ice Pan	1	2002-959
B	Pan Head Screw, #10-24 X 3/4"	4	8068-025
C	Washer, #10 Flat	4	8003-014
D	Nylon-Insert Lock Nut, #10-24	4	8001-002

### Tools Required:

- (1) #2 Phillips Head Screwdriver
- (1) 3/8" Wrench
- (1)  $\varnothing 13/64$ " Drill Bit

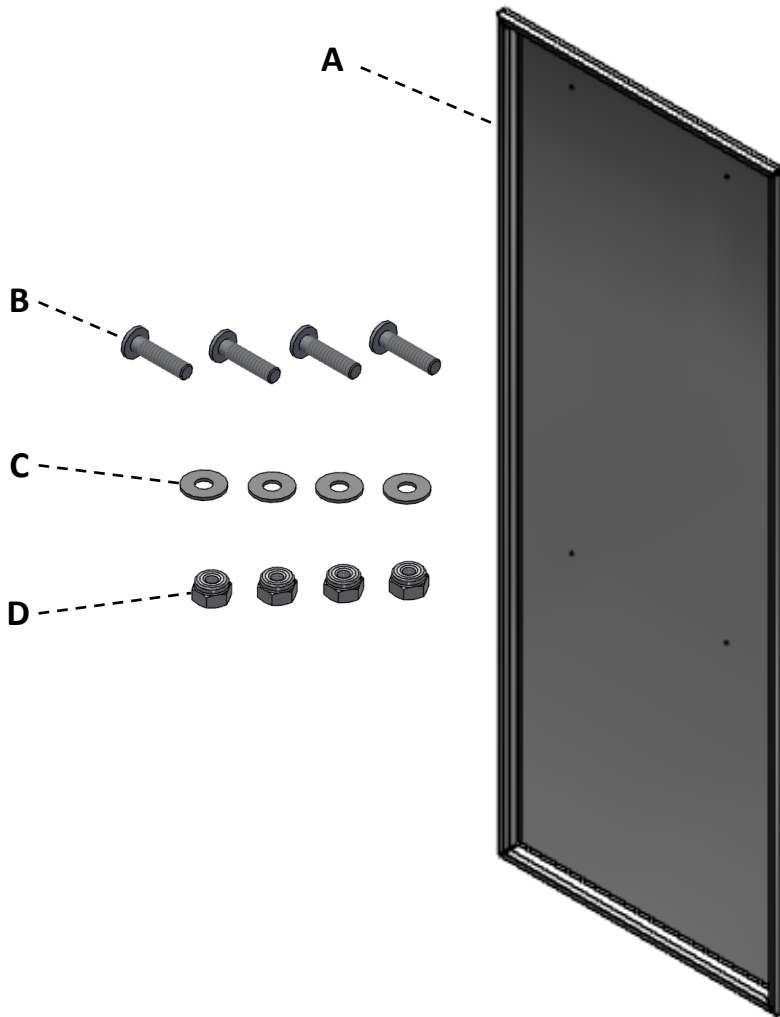

\*Handle, frame, nose plate, and wheels will vary based on the options selected at the time of purchase.

[www.bpmfg.com](http://www.bpmfg.com)

8051 East Boon Road | Cadillac, MI 49601

(800) 334-7141

**b&p Manufacturing**  
Engineered Delivery Products

# Ice Pan Assembly Instructions

1. Center the ice pan (A) onto the hand truck as shown. Without allowing the ice pan to move on the hand truck, transfer drill the four (4) hole locations of the ice pan through the first layer of the frame of the hand truck. \*The drill size may be slightly larger than the holes in the hand cart. This is OK.

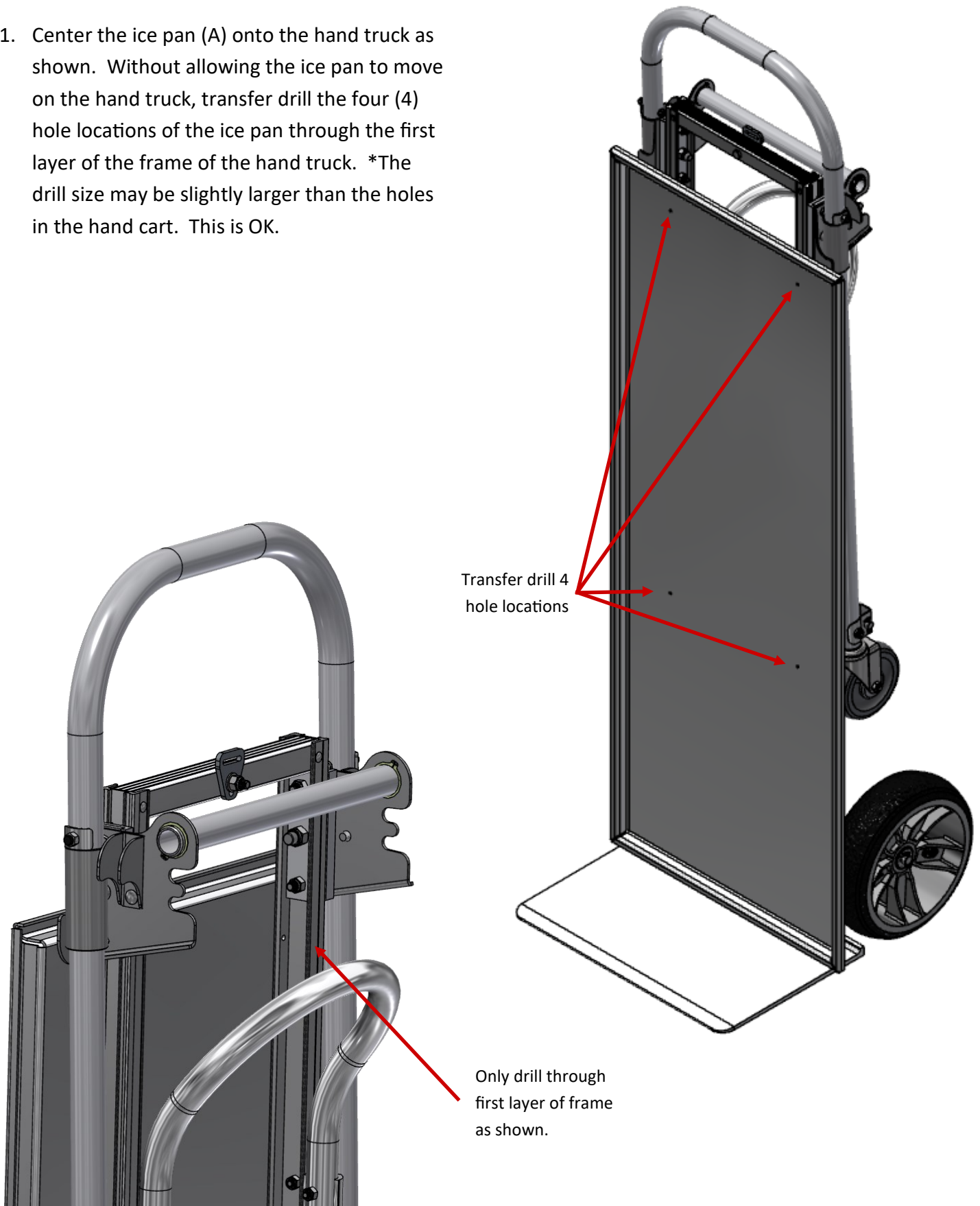

# Ice Pan Assembly Instructions

2. Fasten the ice pan to the hand truck frame through the four drilled holes using four each pan head screws (B), washers (C) and nylon-insert nuts (D).

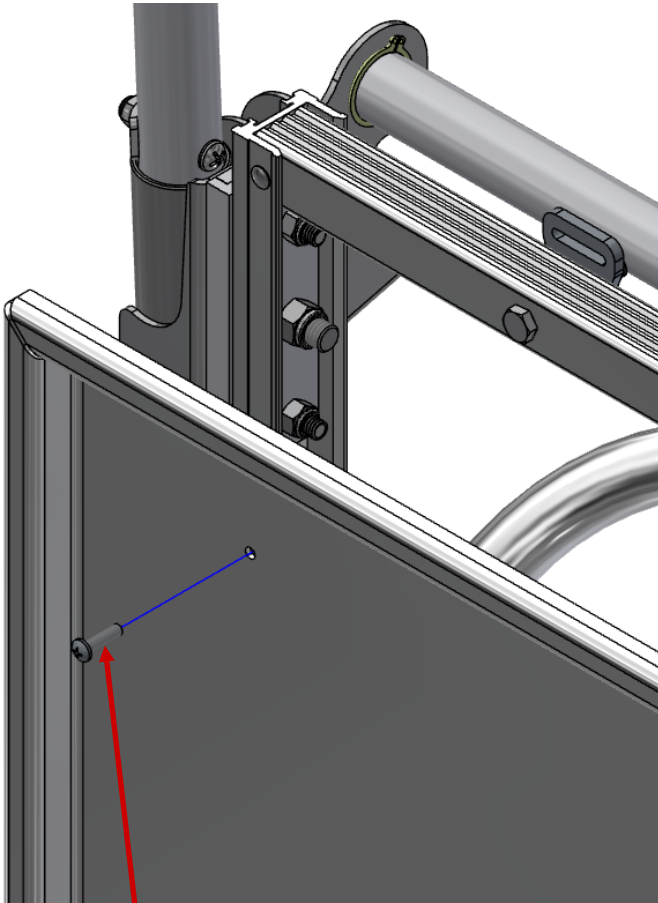

Phillips-drive Pan Head Screw (A)

Washer and Nylon-insert Nut (C & D)

